

# COMMERCIAL & INDUSTRIAL

# 50KW/ 100.3KWH

# ENERGY STORAGE SYSTEM



INDOOR



OUTDOOR

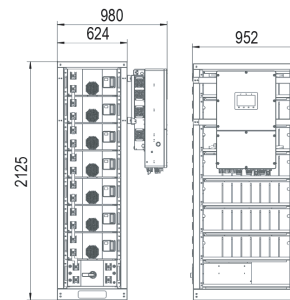
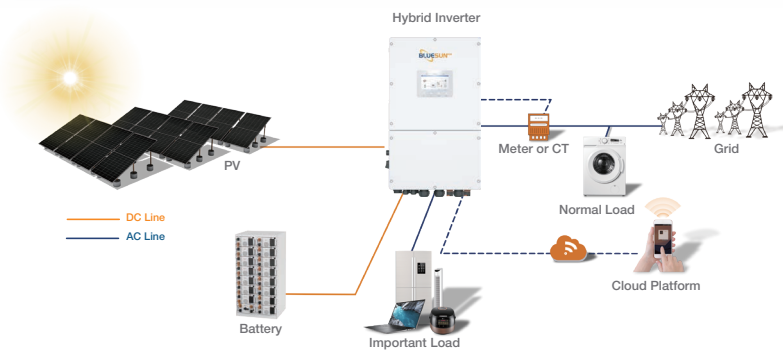

INDOOR

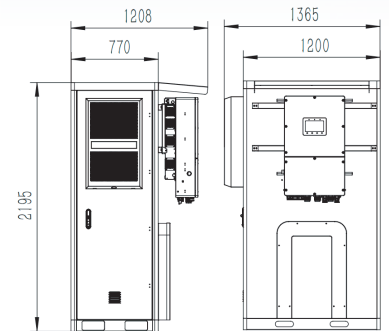

OUTDOOR

## SYSTEM CONFIGURATION

Number	Product name	Specification model	Unit	Quantity	Remark
1	Photovoltaic module	BSM570M10-72HPH	block	96	16 pieces/string; total 6 strings; total 54.72kWp
2	Dc combiner box	6 input and 6 output	piece	1	1000V open circuit voltage, component short circuit current 14.14A
3	Hybrid inverter	BSE50KH3	piece	1	Three-phase 400V 50Hz 4 groups of mppt, 2 strings per group
4	Lithium battery	51.2V 280Ah(including BMU/ Collecting harness/ power cable)	pack	7	7 blocks 1 group, a total of 1 group, total 100.352kWh
5		Control box	piece	1	
6		Battery Rack	set	1	
7		Battery-inverter cable	piece	2	Estimated quantity: Current meets 100A, two batteries per cluster 35 square cabl
8	Remote monitoring	WiFi	set	1	equipped
9	MC4 connector	The type of a one-to-one correspondence	pair	24	
10	Photovoltaic cable	PV1-F 1*4mm <sup>2</sup>	meter	600	
11	Support	Support for 96 photovoltaic modules	set	1	

# 50KW/100.3KWH ENERGY STORAGE SYSTEM

## Model

BSE50KH3-100.3KWH

### SYSTEM PARAMETER

Rated output power	50KW
System capacity	100.3KWH
Battery type	LIFEPO4
Class of protection	IP32/IP56(outdoor)
Quality guarantee	5 years

### INVERTER TECHNICAL PARAMETERS

Model number	BSE50KH3
Maximum photovoltaic input power	100KW
Maximum photovoltaic input current	40A*4
Maximum photovoltaic input voltage	1000V
Number of MPPT/number of strings per route	4/8
MPPT voltage range	180-850V
Maximum photovoltaic short circuit current	60A*4
Maximum charge and discharge current	140A
Maximum charge and discharge power	50kw
Rated grid frequency	50/60Hz
Rated output voltage	380/400V, 3L/N/PE
Phase number	3
Backup power supply	50KW
Communication mode	Wi-Fi/GPRS/4G
Starting voltage	150V
Humidness	0-100%
Dimensions (HxWxD)	800 x 350 x 875 mm
Weight	423kg

### BATTERY TECHNICAL PARAMETERS

Battery module model	51.2V 280AH
Module capacity	14.3KWH
Available capacity	12.8KWH
Discharge depth	90%
Rated voltage	358.4V
Maximum charge and discharge current	140A
Operating temperature range	0~55/-10~55(outdoor)
Cycle number <sup>[1]</sup>	>8000

[1] Test conditions: 0.2C Charging/Discharging,@25°C, 80%DoD